

WSP UK Document & Drawing Issue Sheet



Project No: 70009682
 Project Name: Aylesbury Estate Plot 18
 Date of Issue: 25-Apr-2016
 Purpose of Issue: For Approval
 Method of Issue: Email
 Number of items Issued: 6
 Format of Issue: DRAWINGS & DOC (PDF)
 Service: INFRASTRUCTURE

Issue No: 10
 Issuing Office:
 Unit 9, The Chase, John Tate
 Road, Foxholes Business Park,
 Hertford, SG13 7NN
 Tel: +44 1992 526 000
 Fax: +44 1992 526 001

Issued to:		No of Recipients: 21
Company	Name	Position/Function
London Borough of Southwark	Robson Mupani / Iaan Smuts	
HTA	Mark Donaldson	
HTA	Charlie Hodder	
HTA	Simon Bayliss	
Douggan Morris	Sandi Johnen	
Douggan Morris	Harriet Brisley	
Notting Hill Housing Trust	Jeanette Kenyon	
Arcadis	Nigel Pittam	
Arcadis	Alexander Malloy	
Arcadis	Roger Scott	
Arcadis	Bhavesh Bhuda	
GL Hearne	Sarah Hiscutt	
GL Hearne	Emma Gill	
Aecom	Matthew Palmer	
Aecom	Jennifer Allen	
Aecom	James Wrixon	
Aecom	Eric Roberts	
Aecom	Jonathan Umpleby	
Aecom	Simon Jones	
RLF	Dominic Searle	
WSP	Wayne Fortune	

Dwg/Doc Number	Title	Scale	Size	Revision
NHH-AES-WSP-C-PLOT18-X-XX-M2_GA001	Highways Infrastructure	1:250	A1	G
NHH-AES-WSP-C-PLOT18-X-XX-M2_GA002	Vehicular Swept Paths	1:500	A1	F
NHH-AES-WSP-C-PLOT18-X-XX-M2_GA003	Road contours & Levels	1:250	A1	D
NHH-AES-WSP-C-PLOT18-X-XX-M2_001	Highway lighting	1:250	A1	D
NHH-AES-WSP-C-D01-00-M2_PLOT 18 D001	Drainage Strategy	1:250	A1	E
NHH-AES-WSP-C-PLOT 18-X-XX-RP-DSR	Drainage Strategy Report			Rev 2

DO NOT SCALE

KEY

PROPOSED 6 METRE COLUMN COMPLETE WITH URBIS EVOLVO
 2 LUMINAIRE TO LBS SPECIFICATION.
 MOUNTING HEIGHT: 6M
 OUTREACH BRACKET ARM: 0.5M
 PAINT FINISH: RAL 9005 JET BLACK
 LUMINAIRE & OPTIC: URBIS EVOLVO 2020/132-24 27075C
 LAMP: 60 WATT CPO-TW
 TILT: 0°
 GLAZING: CURVED TEMPERED GLASS
 CONTROL GEAR: INTEGRAL ELECTRONIC
 PECU: NEMA SOCKET ELECTRONIC PHOTOCELL SET TO SWITCH AT 35/18 LUX.

PROPOSED 6 METRE COLUMN COMPLETE WITH URBIS EVOLVO
 2 LUMINAIRE TO LBS SPECIFICATION.
 MOUNTING HEIGHT: 6M
 OUTREACH BRACKET ARM: 0.5M
 PAINT FINISH: RAL 9005 JET BLACK
 LUMINAIRE & OPTIC: URBIS EVOLVO 2020/132-24 27075E
 LAMP: 60 WATT CPO-TW
 TILT: 0°
 GLAZING: CURVED TEMPERED GLASS
 CONTROL GEAR: INTEGRAL ELECTRONIC
 PECU: NEMA SOCKET ELECTRONIC PHOTOCELL SET TO SWITCH AT 35/18 LUX.

15 INDICATIVE ISOLUX CONTOUR (REFER TO DRAWING FOR VALUE)

NOTES:

- LIGHTING CALCULATIONS PERFORMED TO THE REQUIREMENTS OF BS 5489-1:2013, BS EN13201-2:2015 AND LONDON BOROUGH OF SOUTHWARK LIGHTING DESIGN GUIDE.
- ALL EQUIPMENT TO BE MADE ELECTRICALLY SAFE PRIOR TO COMMENCEMENT OF WORKS.
- ALL ELECTRICAL WORKS TO BE CARRIED OUT IN ACCORDANCE WITH BS 7671:2008 (AS 2015) IET WIRING REGULATIONS 17TH EDITION.
- CONTRACTOR TO LIAISE WITH DISTRIBUTION NETWORK OPERATOR PRIOR TO COMMENCEMENT OF WORKS.
- COLUMNS TO BE DESIGNED TO BS EN 40 AND LONDON BOROUGH OF SOUTHWARK SPECIFICATION.
- ALL WORKS TO BE CARRIED OUT IN ACCORDANCE WITH THE LONDON BOROUGH OF SOUTHWARK PUBLIC REALM EXTERIOR LIGHTING DESIGN GUIDE.

CALCULATION RESULTS SUMMARY

REFER TO MAIN CALCULATION FOR DETAILED CALCULATION RESULTS

Eav = 13.56 LUX
 Emin = 3.02
 Uo = 0.22

D	25/04/2016	PJB	REVISED LANDSCAPE ARCHITECTS LAYOUT	RCF	CF
C	22/04/2016	PJB	REVISED LANDSCAPE ARCHITECTS LAYOUT	RCF	CF
B	15/12/2015	PJB	REVISED ARCHITECTS LAYOUT	RCF	CF
A	12/10/2015	PJB	FIRST ISSUE	RCF	CF

REV	DATE	BY	DESCRIPTION	CHK	APD

DRAWING STATUS: PLANNING APPLICATION

WSP | PARSONS BRINCKERHOFF

Unit 9, The Chase, John Tate Road
 Foxholes Business Park, Hertford SG13 7NN
 Tel: +44 (0)1992 526000 Fax: +44 (0)1992 526001
 www.wspgroup.com www.pbworld.com

CLIENT: NHH

ARCHITECT: HTA

PROJECT: AYLESBURY ESTATE SOUTHWARK

TITLE: PLOT 18 HIGHWAY LIGHTING

SCALE @ AT: 1:250	CHECKED: RCF	APPROVED: CF
CAD FILE: 9682-1300-001-D.DWG	DESIGN/DRAWN: PJB	DATE: April 16

PROJECT No: 70009682	DRAWING No: 9682-1300-001-D	REV: D
----------------------	-----------------------------	--------

PROJECT DOCUMENT REF: NHH-AES-WSP-C-PLOT18-X-XX-M2_001

© WSP Group Ltd

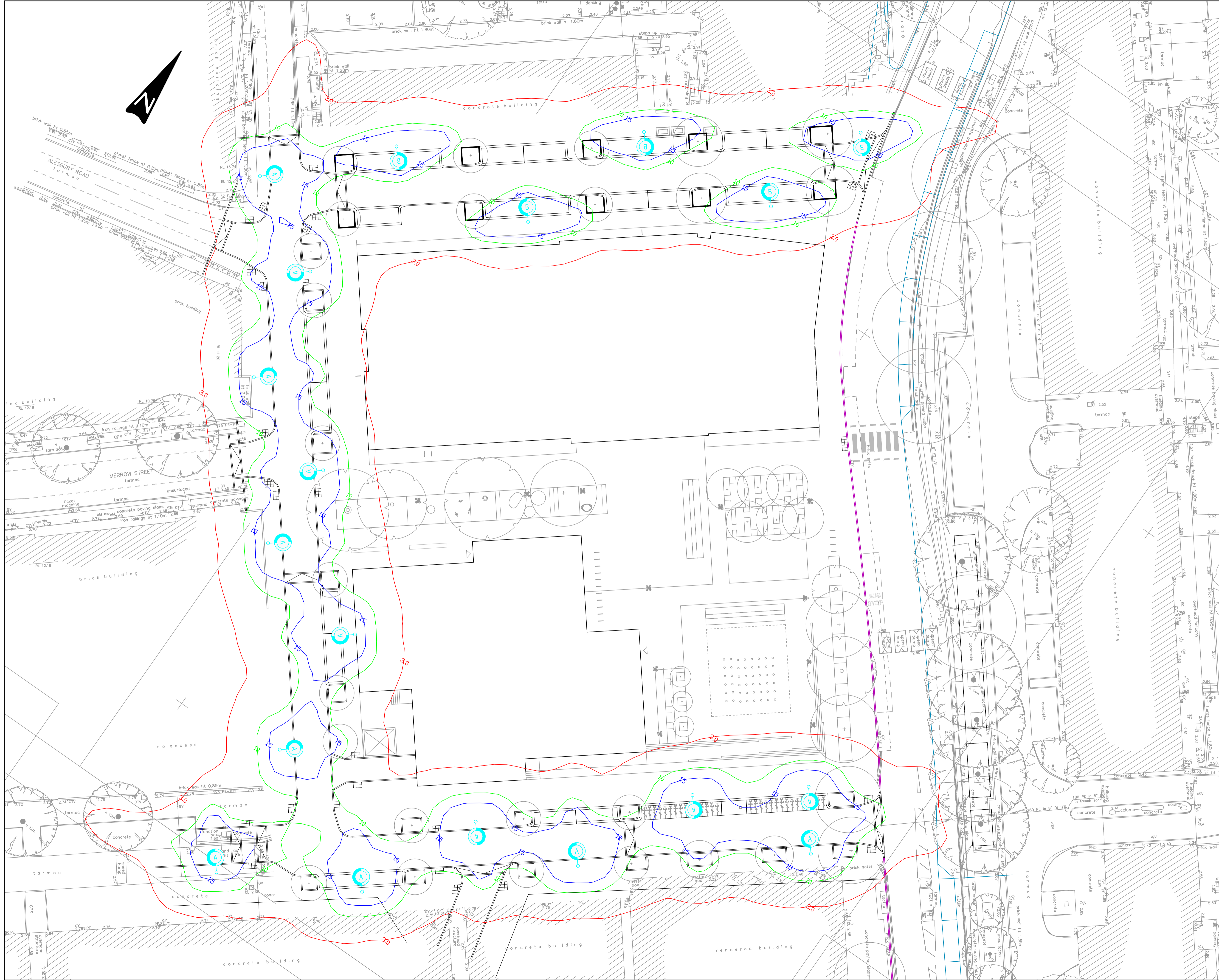

n:\02 other offices\lighting other offices\70009682 - aylesbury est plot 18\c models and drawings\03 lighting\01 current drawings\9682-1300-001-d.dwg, 25 April 2016 16:01:54, Batchelor, Paul

DO NOT SCALE

- NOTES
- THIS DRAWING SHALL BE READ IN CONJUNCTION WITH ALL RELATED DOCUMENTATION, DRAWINGS AND STANDARD DETAILS.
 - THE WORKS SHALL BE CARRIED OUT IN ACCORDANCE WITH SEWERS FOR ADOPTION 7TH EDITION
 - ALL DRAINAGE OUTFALLS AND CONNECTIONS TO EXISTING SYSTEMS SHALL BE CHECKED & SURVEYED AND THE RESULTS PASSED TO THE OVERSEEING AUTHORITY / CLIENT IN ADVANCE OF THE START OF DRAINAGE WORKS.

- KEY:
- PROPOSED COMBINED SEWER
 - PROPOSED SURFACE WATER SEWER
 - PROPOSED FOUL SEWER
 - PROPOSED HIGHWAY DRAINAGE
 - OVERLAND FLOW ROUTE FOR EXCEEDENCE OVER 1 IN 100 YEAR EVENT PLUS 30% FOR CLIMATE CHANGE
 - INDICATIVE ROAD LEVEL

REV	DATE	BY	DESCRIPTION	CHK	APD
E	25/04/2016	CM	INTERNAL LANDSCAPE LAYOUT UPDATED	CM	MGS
D	22/04/2016	PBB	REVISED TO SUIT REVISIONS TO ROAD LEVELS	CM	MGS
C	01/04/2016	SJF	DRAINAGE UPDATED TO SUIT LATEST LANDSCAPE LAYOUT	CS	MGS
B	17/11/2015	SJF	LEVELS AND FLOW ARROWS ADDED	CS	MGS
A	29/09/2015	SJF	FIRST ISSUE	CS	MGS

DRAWING STATUS: PLANNING APPLICATION

WSP | **PARSONS BRINCKERHOFF**

Unit 9, The Chase, John Tate Road
 Foxholes Business Park, Hertford SG13 7NN
 Tel: +44 (0)1992 526000 Fax: +44 (0)1992 526001
 www.wspgroup.com www.pbworld.com

CLIENT: NHH
 ARCHITECT: HTA
 PROJECT: AYLESBURY ESTATE SOUTHWARK
 TITLE: PLOT 18 DRAINAGE STRATEGY

SCALE @ A1: 1:250	CHECKED: CS	APPROVED: MGS
CAD FILE: 9682-D-001.DWG	DESIGN DRAWN: SJF	DATE: September 15
PROJECT No: 70009682	DRAWING No: 9682-D-001	REV: E
PROJECT DOCUMENT REF: NHH-AES-WSP-C-D01-00-M2_PLOT 18 D001		
© WSP Group Ltd		

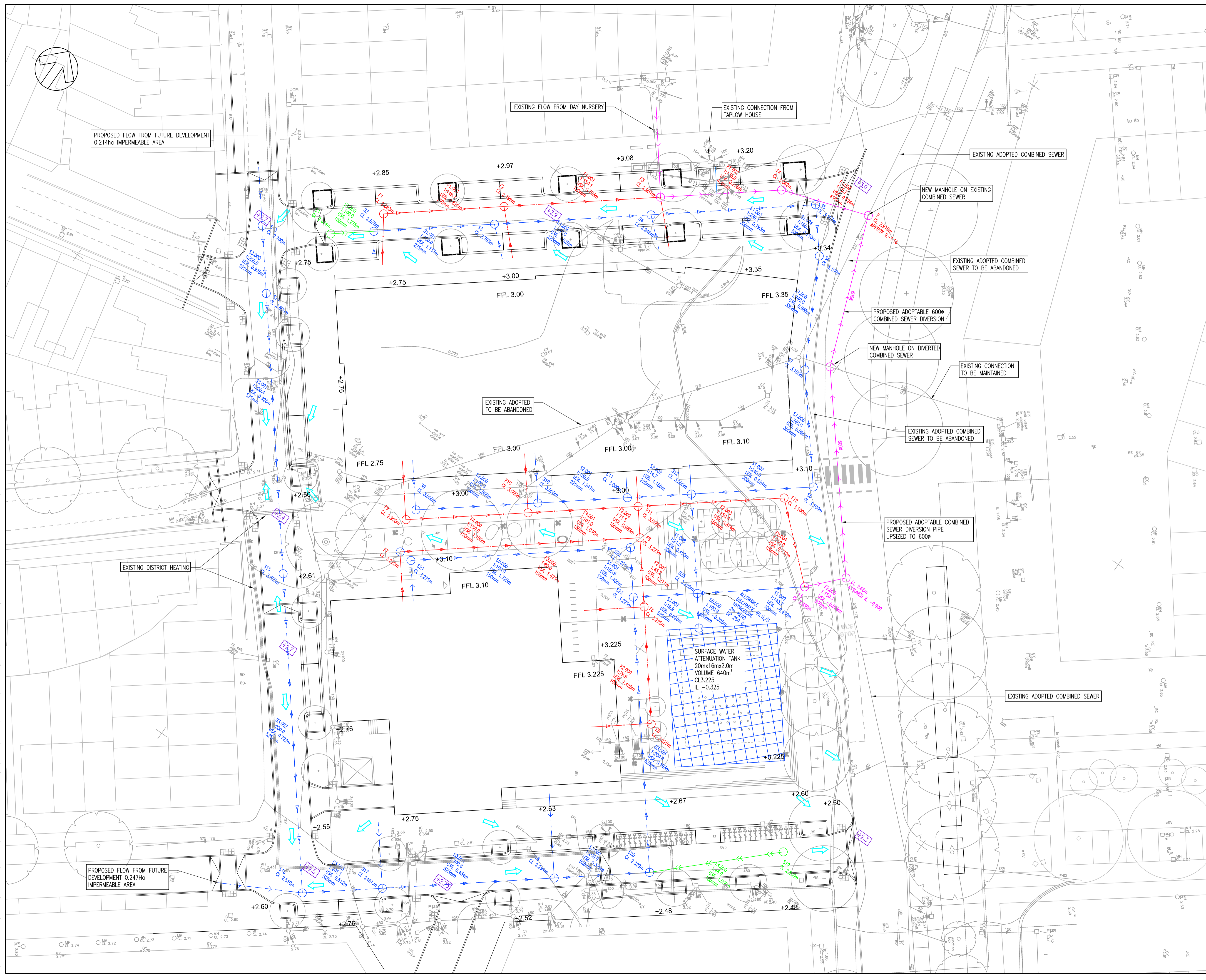

n:\70009682 - aylesbury estate plot 18\e models and drawings\development\autocad\drainage\9682-d-001.dwg, 25 April 2016 15:02:59, Moriarty, Ciara

DO NOT SCALE

- GENERAL NOTES**
- THIS GENERAL ARRANGEMENT IS NOT TO BE USED FOR CONSTRUCTION. DIMENSIONS SHALL NOT BE SCALED FROM THIS DRAWING. ALL DIMENSIONS SHOWN ARE IN METRES.
 - ALL HIGHWAY WORKS ARE TO BE IN ACCORDANCE WITH THE SOUTHWARK STREETScape DESIGN MANUAL.
 - FOR KERB PROFILES REFER TO SOUTHWARK STREETScape DESIGN MANUAL:-
 - CARRIAGEWAY EDGE - TYPE 1 K15-T1 (H/S) 150X300
 - TAPER - K15-T1 (H/S) D1
 - DROPPED - K15-T1 (L/S) 150X150
 - PARKING BAYS - K30-T1 (H/S) 300X300
 - TRANSITIONS - K15/30-T1 (H/S)
 - PARKING BAY FRONT - K30-TM (M/S) 225X300
 - INTERNAL CORNERS - KA30 (90/H) 300X300
 - DOUBLE STEP - K15-T1 (H/S) 150X300 & 150X225

- VEHICULAR VISIBILITY SPY 2.4m x 18m/25m/43m
- PEDESTRIAN VISIBILITY SPY 25m FROM BACK OF TACTILE 1m OFFSET FROM CHANNEL ON NEAR-SIDE LANE
- TRAFFIC CALMING RAMP TO RAISED TABLE OR TRAFFIC CARPET
- PROPOSED CARRIAGEWAY EDGE
- PROPOSED TACTILE PAVING TO PEDESTRIAN CROSSING
- PROPOSED ROAD GULLY
- SLOT DRAIN

REV	DATE	BY	DESCRIPTION	CHK	APD
G	25/04/2016	CM	INTERNAL LANDSCAPE LAYOUT UPDATED	CM	MGS
F	22/04/2016	SJF	REVISED ARCHITECT LAYOUT 23 MAR 2016	CM	MGS
E	17/12/2015	SJF	REVISED LAYOUT	CS	MGS
D	15/10/2015	SJF	RAMP ON ROAD 2 LOCATION REVISED AND GULLY POSITIONS AMENDED.	CS	MGS
C	13/10/2015	SJF	REVISED DUE TO LSC COMMENTS 1 OCT 2015. DRAWING NUMBER AND TITLE AMENDED.	CS	MGS
B	29/09/2015	SJF	REVISED ARCHITECTS LAYOUT 29 SEP 2015	CS	MGS
A	17/09/2015	SJF	FIRST ISSUE	CS	MGS

DRAWING STATUS: **PLANNING APPLICATION**

Unit 9, The Chase, John Tate Road
 Foxholes Business Park, Hertford SG13 7NN
 Tel: +44 (0)1992 526000 Fax: +44 (0)1992 526001
 www.wspgroup.com www.pbworld.com

CLIENT: **NHH**

ARCHITECT: **HTA**

PROJECT: **AYLESBURY ESTATE SOUTHWARK**

TITLE: **PLOT 18 HIGHWAYS INFRASTRUCTURE GENERAL ARRANGEMENT**

SCALE @ 1: 1:250	CHECKED: CS	APPROVED: MGS
CAD FILE: 9682-GA-001.DWG	DESIGN-DRAWN: SJF	DATE: September 15

PROJECT No: 70009682	DRAWING No: 9682-GA-001	REV: G
----------------------	-------------------------	--------

PROJECT DOCUMENT REF: **NHH-AES-WSP-C-PLOT18-X-XX-M2_GA001**

© WSP Group Ltd

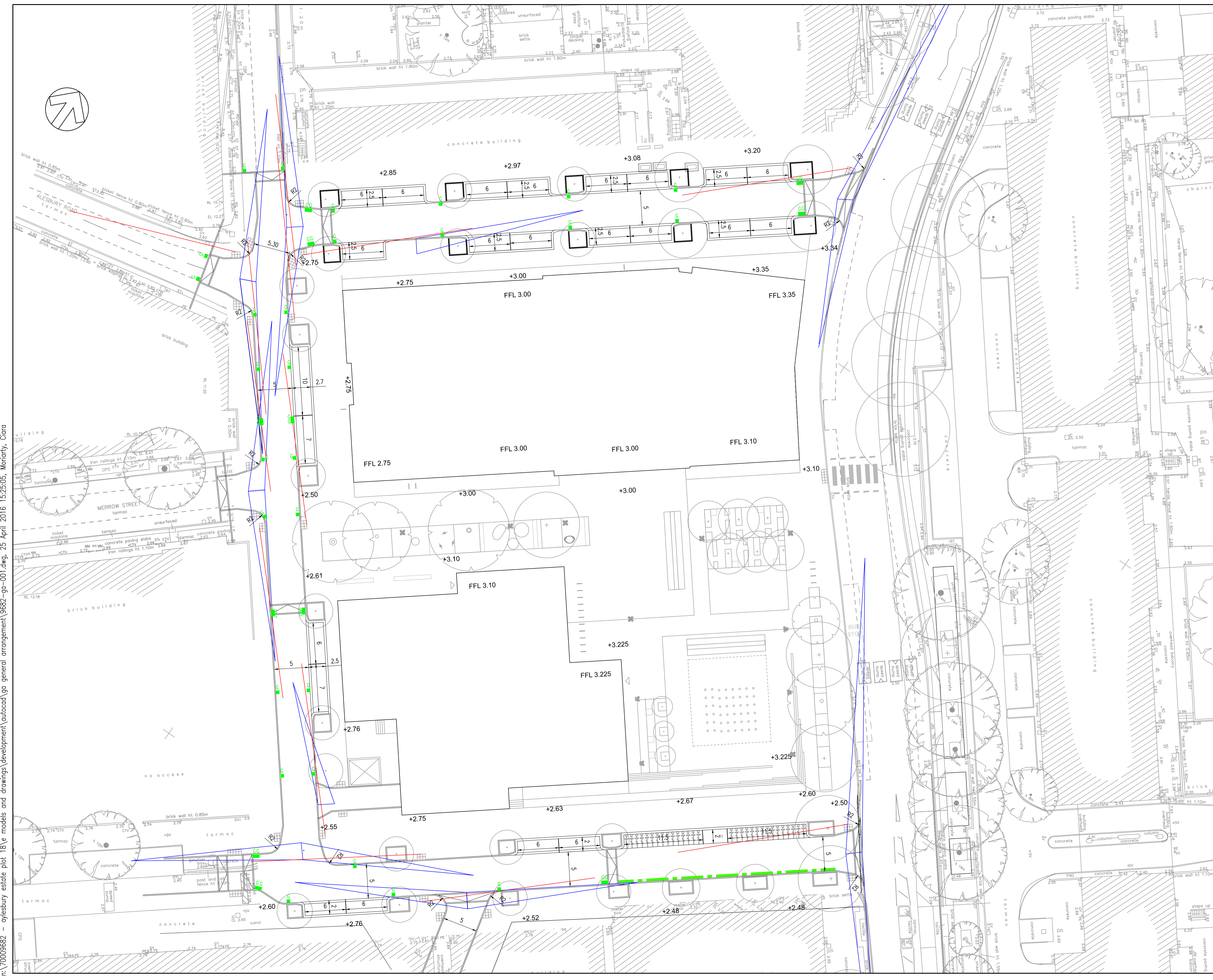

n:\70009682 - aylesbury estate plot 18\development\drawings\development\autocad\ga general arrangement\9682-ga-001.dwg, 25 April 2016 15:25:05, Moriarty, Ciara

DO NOT SCALE

NOTES

- DRAWING BASED ON TOPOGRAPHICAL SURVEY SUPPLIED BY THE CLIENT AND PRODUCED BY TERRAIN LAND AND ARCHITECTURAL SURVEYORS DATED APRIL 2014.
- ALL HIGHWAY WORKS TO BE IN ACCORDANCE WITH THE SOUTHWARK STREETScape DESIGN MANUAL.

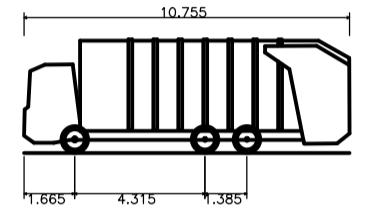

Phoenix 2 Duo Recycler (P2-12W with Elite 6x2 MS chassis)
 Overall Length 10.75m
 Overall Width 4.31m
 Overall Body Height 3.75m
 Min Body Ground Clearance 0.30m
 Track Width 2.50m
 Lock to Lock Time 4.0s
 Kerb to Kerb Turning Radius 11.450m

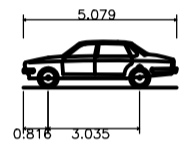

Large Car (2006)
 Overall Length 5.07m
 Overall Width 1.82m
 Overall Body Height 1.52m
 Min Body Ground Clearance 0.31m
 Max Track Width 1.831m
 Lock to Lock Time 4.0s
 Kerb to Kerb Turning Radius 5.900m

REV	DATE	BY	DESCRIPTION	CHK	APP
F	25/04/2016	CM	INTERNAL LANDSCAPE LAYOUT UPDATED	CM	MGS
E	21/04/2016	MM	HIGHWAY LAYOUT UPDATED, REFUSE VEHICLE CHANGED FROM DBS2 TO PHOENIX 2 DUO RECYCLER	CM	MGS
D	14/12/2015	SJF	REVISED LAYOUT	CS	MGS
C	02/11/2015	SJF	UPDATED TO SUIT REVISED LAYOUT	CS	MGS
B	15/10/2015	SJF	DRAWING NUMBER AMENDED, RADIUS AT MERROW STREET REVISED TO 5m	CS	MGS
A	17/09/2015	SJF	FIRST ISSUE	CS	MGS

DRAWING STATUS:					
PLANNING APPLICATION					

WSP | **PARSONS BRINCKERHOFF**

Unit 9, The Chase, John Tate Road
 Foxholes Business Park, Hertford SG13 7NN
 Tel: +44 (0)1992 526000 Fax: +44 (0)1992 526001
 www.wspgroup.com www.pbworld.com

CLIENT: NHH

ARCHITECT: HTA

PROJECT: AYLESBURY ESTATE SOUTHWARK

TITLE: PLOT 18 VEHICULAR SWEEP PATHS

SCALE @ A1: 1:500	CHECKED: CS	APPROVED: MGS
CAD FILE: 9682-GA-002.DWG	DESIGN-DRAWN: SJF	DATE: September 15
PROJECT No: 70009682	DRAWING No: 9682-GA-002	REV: F

PROJECT DOCUMENT REF: NHH-AES-WSP-C-PLOT18-X-XX-M_GA002

© WSP Group Ltd

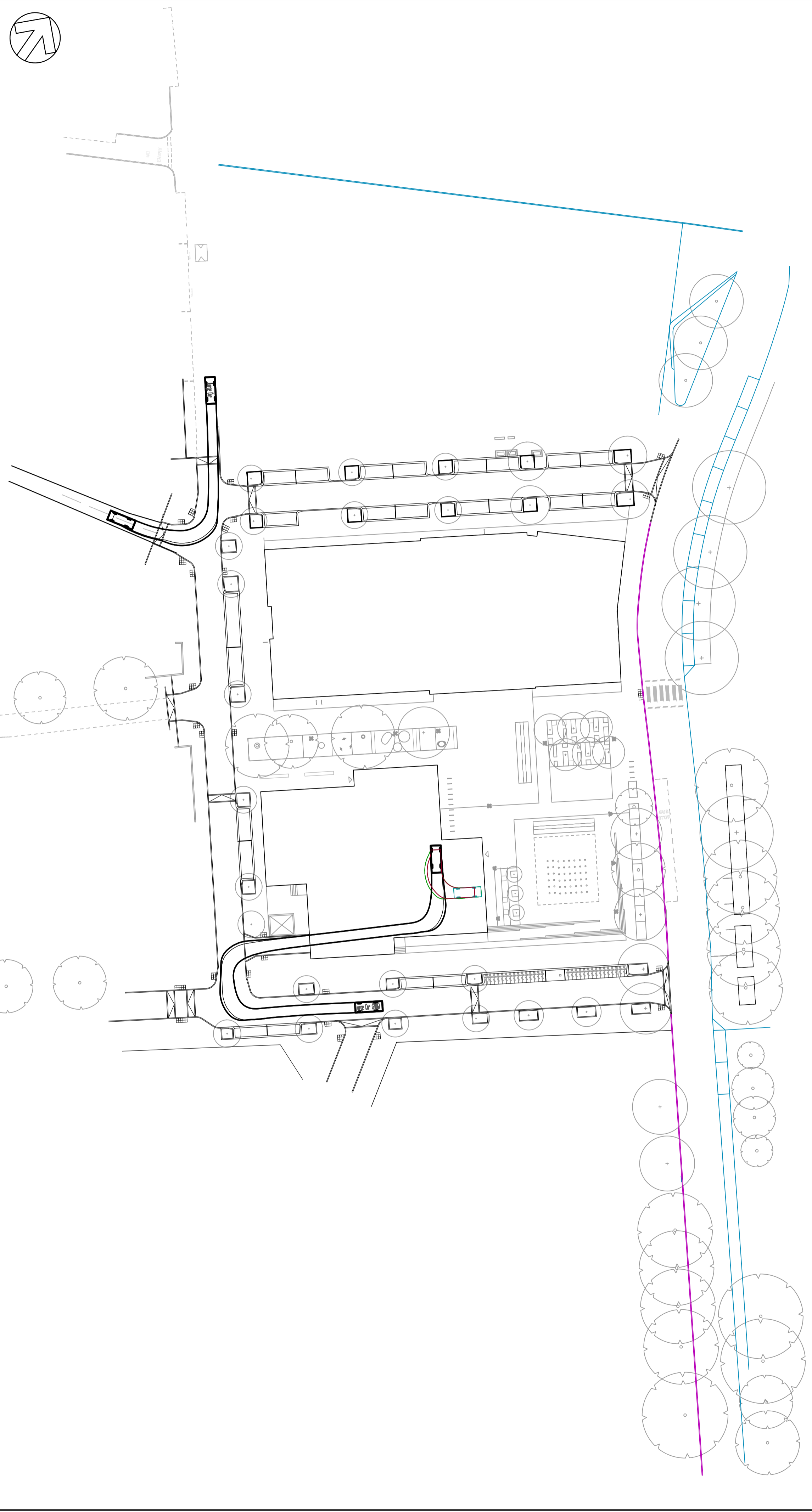
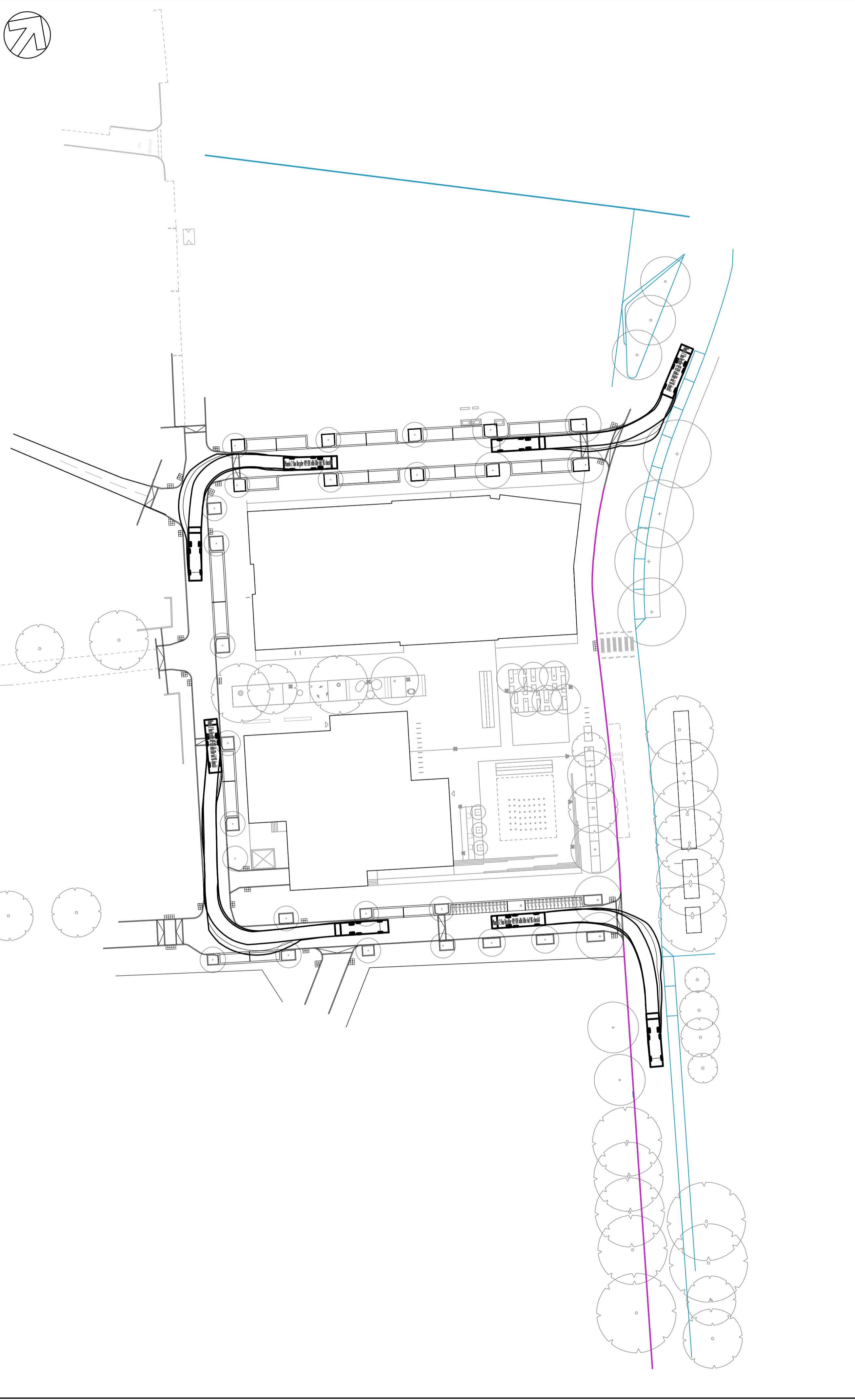

n:\70009682 - aylesbury estate plot 18\e models and drawings\development\autocad\ga general arrangement\9682-ga-002.dwg, 25 April 2016 15:11:01, Moriarty, Ciara

DO NOT SCALE

- GENERAL NOTES
1. THIS GENERAL ARRANGEMENT IS NOT TO BE USED FOR CONSTRUCTION.
 2. DIMENSIONS SHALL NOT BE SCALED FROM THIS DRAWING. ALL DIMENSIONS SHOWN ARE IN METRES.
 3. ALL HIGHWAY WORKS ARE TO BE IN ACCORDANCE WITH THE SOUTHWARK STREETScape DESIGN MANUAL.

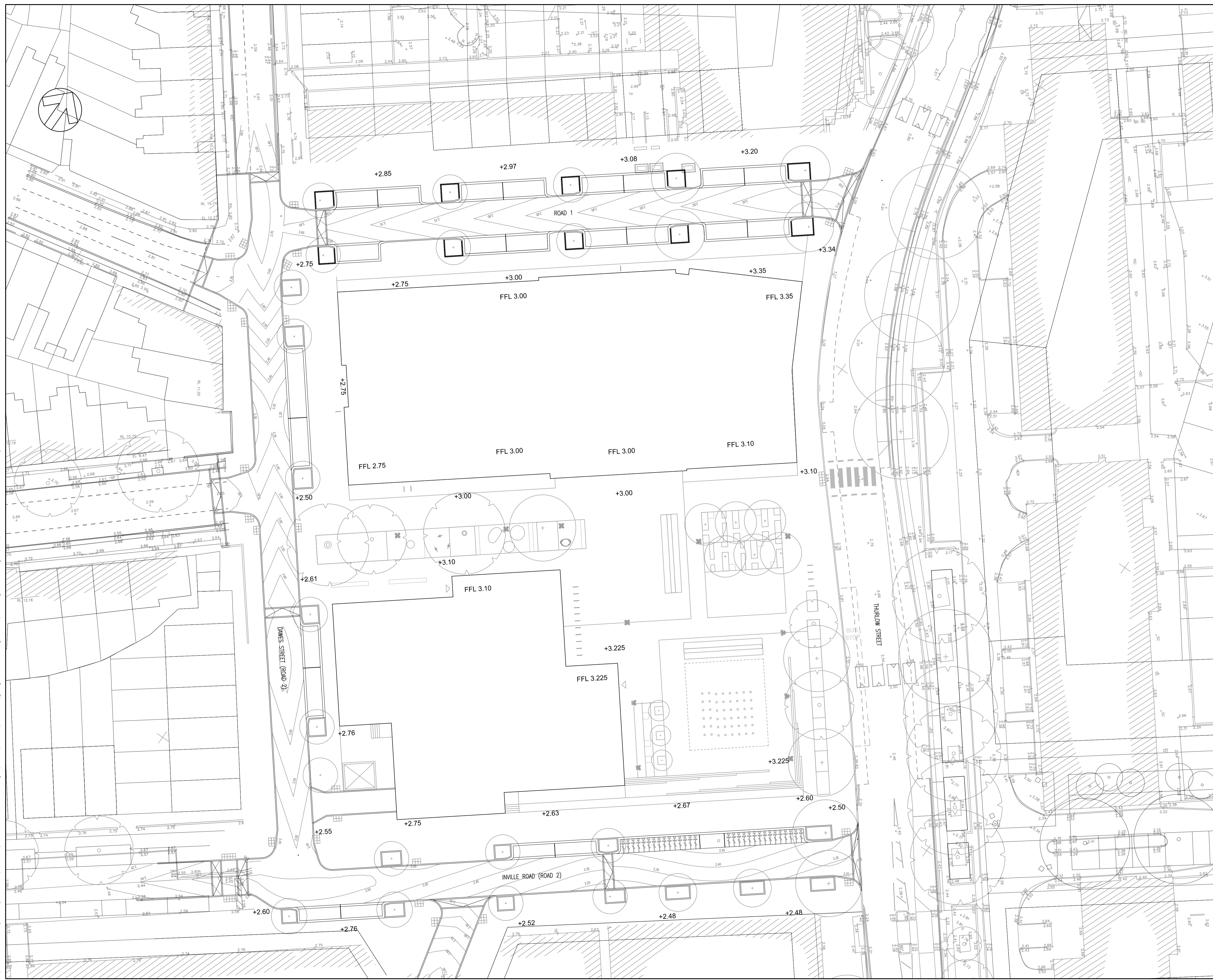

REV	DATE	BY	DESCRIPTION	CHK	APD
D	25/04/2016	CM	INTERNAL LANDSCAPE LAYOUT UPDATED	CM	MGS
C	22/04/2016	SJF	REVISED ARCHITECT LAYOUT 23 MARCH 2016	CM	MGS
B	17/12/2015	SJF	REVISED LAYOUT	CS	MGS
A	14/09/2015	SJF	FIRST ISSUE	CS	MGS

DRAWING STATUS: **PLANNING APPLICATION**

WSP | **PARSONS BRINCKERHOFF**

Unit 9, The Chase, John Tate Road
 Foxholes Business Park, Hertford SG13 7NN
 Tel: +44 (0)1992 526000 Fax: +44 (0)1992 526001
 www.wspgroup.com www.pbworld.com

CLIENT: **NHH**

ARCHITECT: **HTA**

PROJECT: **AYLESBURY ESTATE SOUTHWARK**

TITLE: **PLOT 18 HIGHWAYS INFRASTRUCTURE ROAD LEVELS & CONTOURS**

SCALE @ A1: 1:250	CHECKED: CS	APPROVED: MGS
CAD FILE: 9682-GA-003.DWG	DESIGN DRAWN: SJF	DATE: October 15

PROJECT No: 70009682	DRAWING No: 9682-GA-003	REV: D
----------------------	-------------------------	--------

PROJECT DOCUMENT REF: **NHH-AES-WSP-C-PLOT18-X-XX-M2_GA003**

© WSP Group Ltd

n:\70009682 - aylesbury estate plot 18\e models and drawings\development\autocad\ga general arrangement\9682-ga-003.dwg, 25 April 2016 15:12:28, Moriarty, Ciara

DO NOT SCALE

- GENERAL NOTES
- DIMENSIONS SHALL NOT BE SCALED FROM THIS DRAWING. ALL DIMENSIONS SHOWN ARE IN METRES.
 - ALL HIGHWAY WORKS ARE TO BE IN ACCORDANCE WITH THE SOUTHWARK STREETScape DESIGN MANUAL.

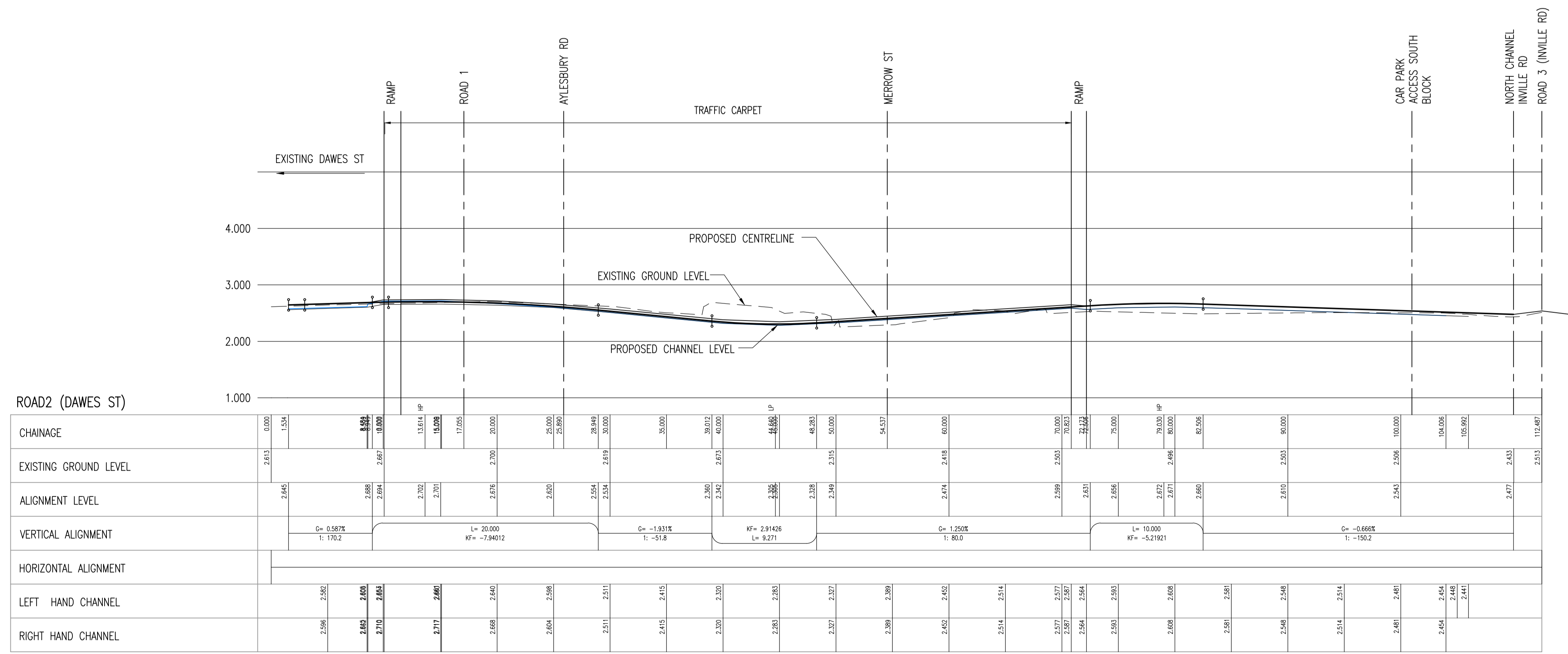
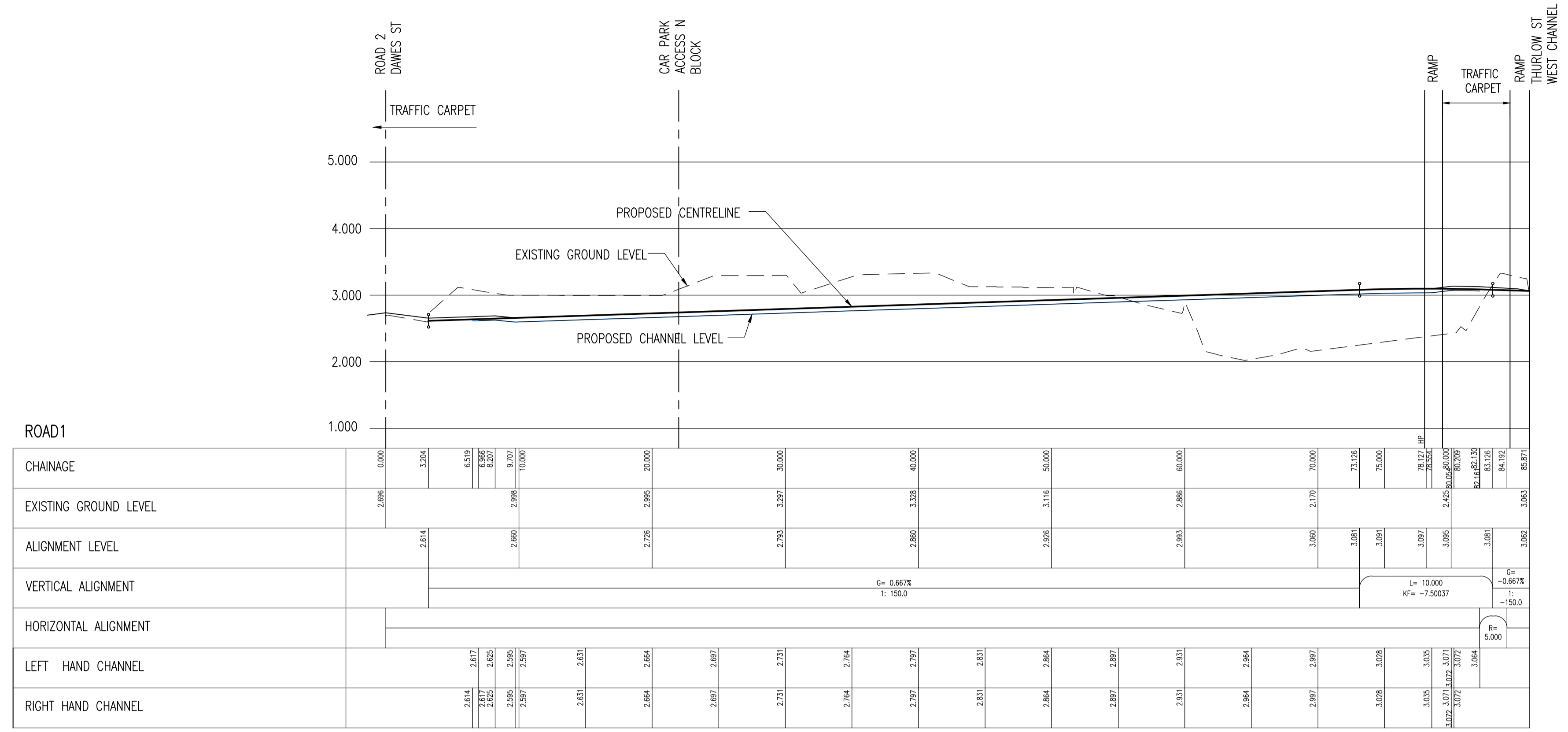

REV	DATE	BY	DESCRIPTION	CHK	APP
B	22/04/2016	PBB	REVISED ARCHITECT LAYOUT 23 MARCH 2016	CM	WGS
A	17/12/2015	SJF	ISSUED	CS	WGS

DRAWING STATUS: PLANNING APPLICATION

CLIENT: NHH

ARCHITECT: HTA

PROJECT: AYLESBURY ESTATE SOUTHWARK

TITLE: PLOT 18 HIGHWAYS INFRASTRUCTURE LONGITUDINAL SECTIONS 1 OF 2

SCALE @ AT: 1:250	CHECKED: CS	APPROVED: MGS
CAD FILE: 9682-RP-001.DWG	DESIGN/DRAWN: SJF	DATE: October 15

PROJECT No: 70009682	DRAWING No: 9682-RP-001	REV: B
----------------------	-------------------------	--------

PROJECT DOCUMENT REF: NHH-AES-WSP-C-PLOT18-X-XX-M2_RP001

© WSP Group Ltd

n:\70009682 - aylesbury estate plot 18\development\drawings\development\autocad\p road and paving levels, sections\9682-rp-001.dwg, 22 April 2016 13:55:11, Fergusson-Thorne, Sarah

